

SPIT PULSA

40E - 40P - 40P+

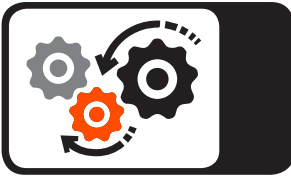

CE



014749

1



Best use before



> 500



3



> 3500



	30%	25 min.
	80%	60 min.
	100%	1h45



2

spit

L 15 > 40 mm

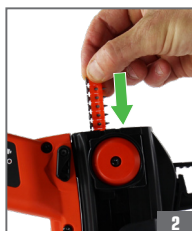

4

-15°C ≤ T ≤ +49°C





014749

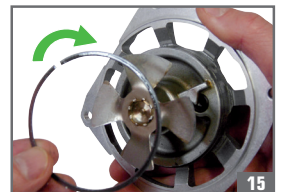
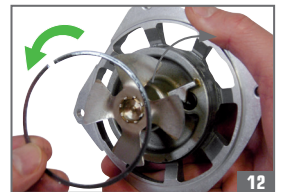
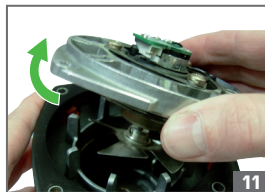
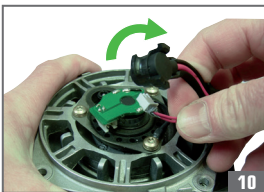
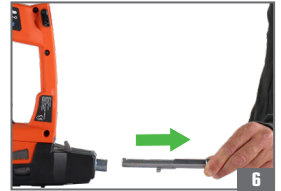
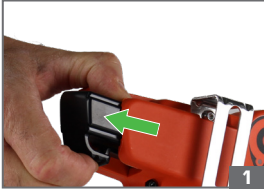

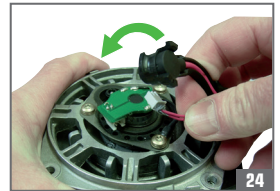
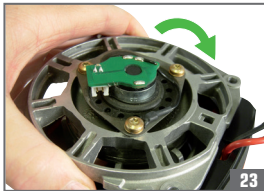
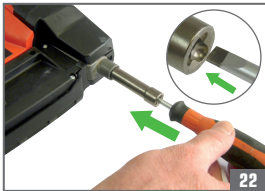
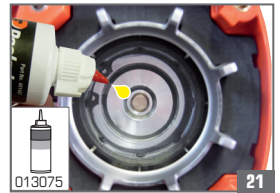
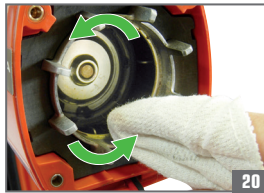
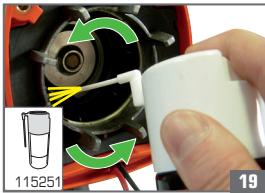
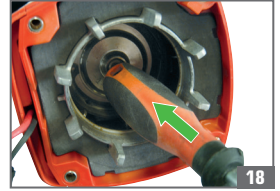
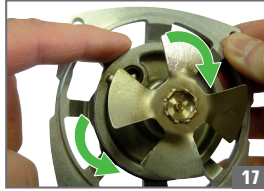
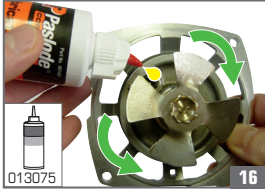



014749

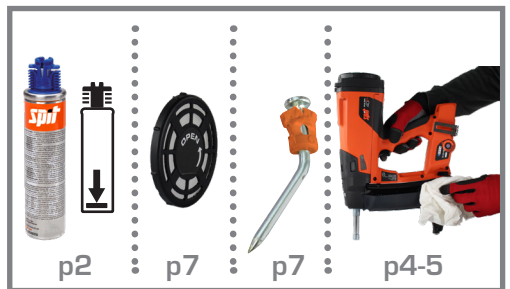
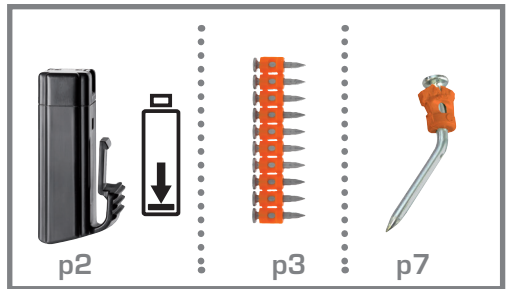

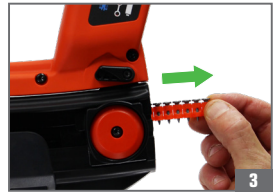
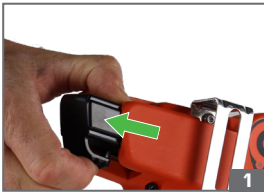
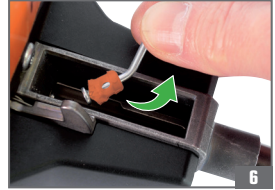
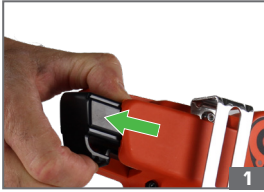

Resting position / Ruheposition / Position de repos / Ruststand / Posición de descanso / Posizione di riposo / Posição de descanso / Pozycja spoczynku / Klidová poloha / Nyugalmi állapot / Положение в нерабочем состоянии / Θέση αδράνειας / Hvilestilling / Viloläge / Hvileposisjon / Lepoasento / Položaj mirovanja / Pokojová poloha / Položaj mirovanja / وضع السكون / Ramybės padėtis / Ooteasend / Miera stāvoklis / Hvíldarstaða



Notes



Notes



Notes

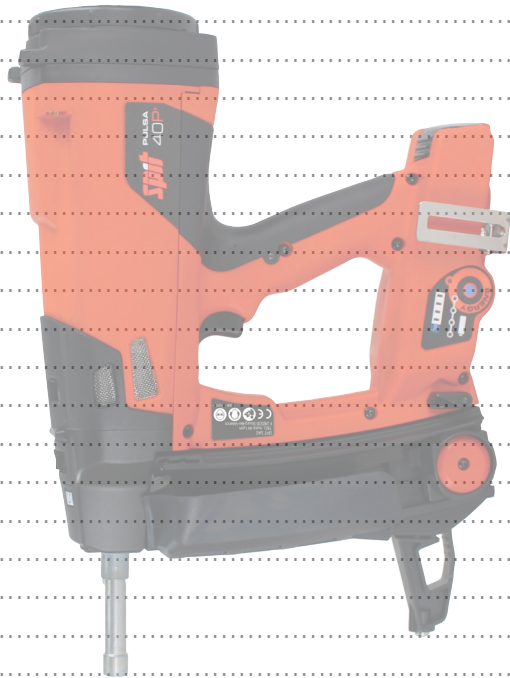

$-15^{\circ}\text{C} \leq T \leq +49^{\circ}\text{C}$

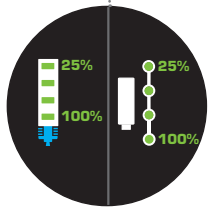
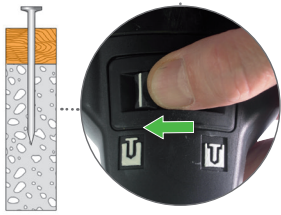

spit

150, Route de Lyon
F-26500 Bourg-lès-Valence
FRANCE



019344-2 12/20