

# INSTRUCTIONS D'INSTALLATION DU PORTAIL À DOUBLE BATTANT SASHA

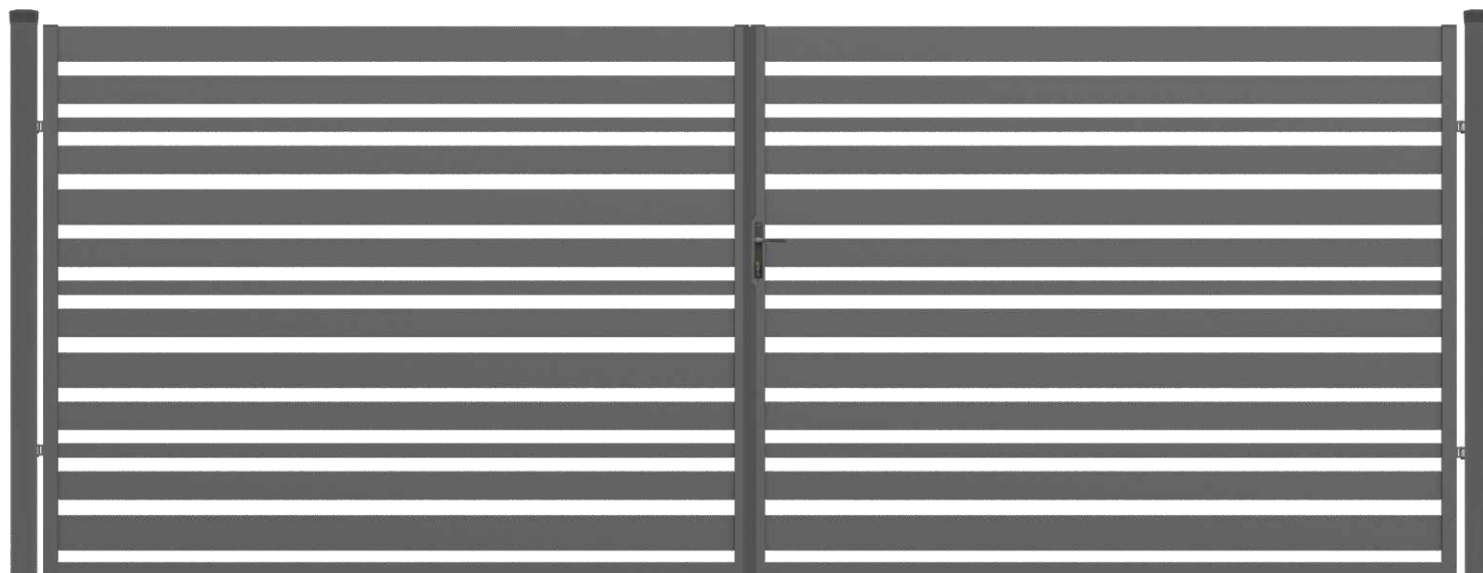

**1,50m x 3,50m**



CERTIFICAT CE



# Portail double complet

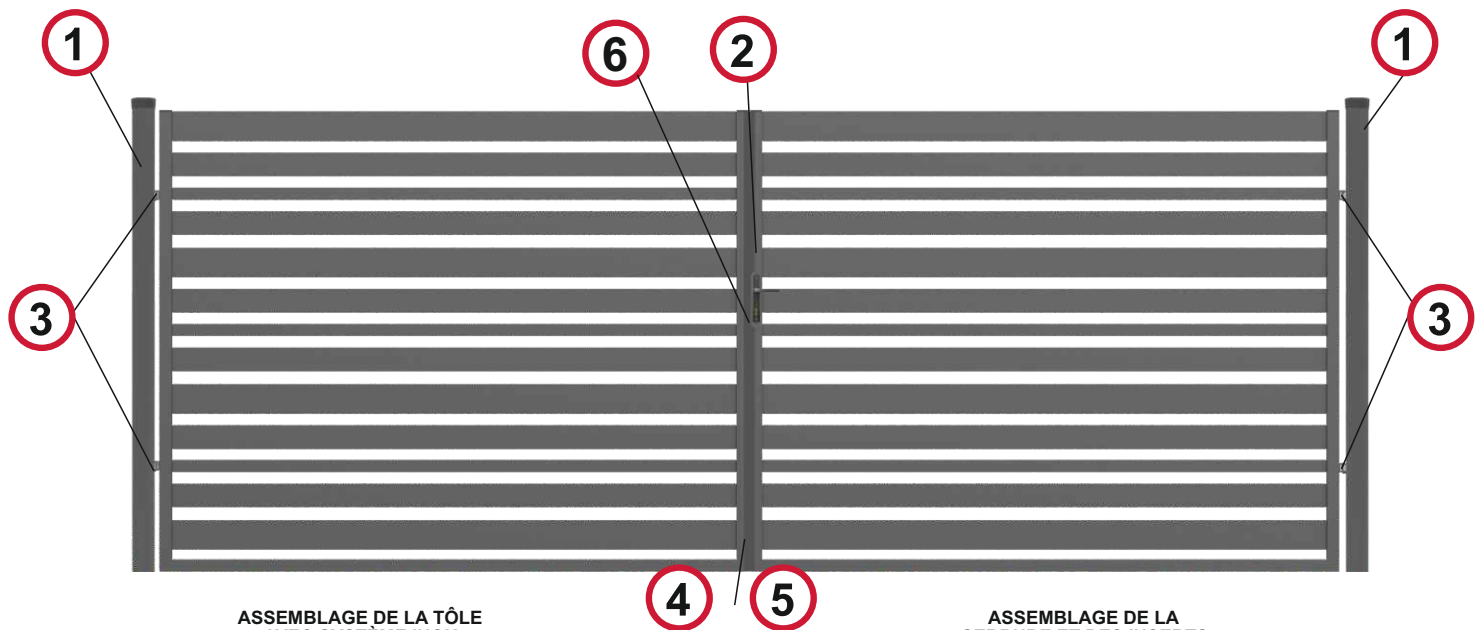
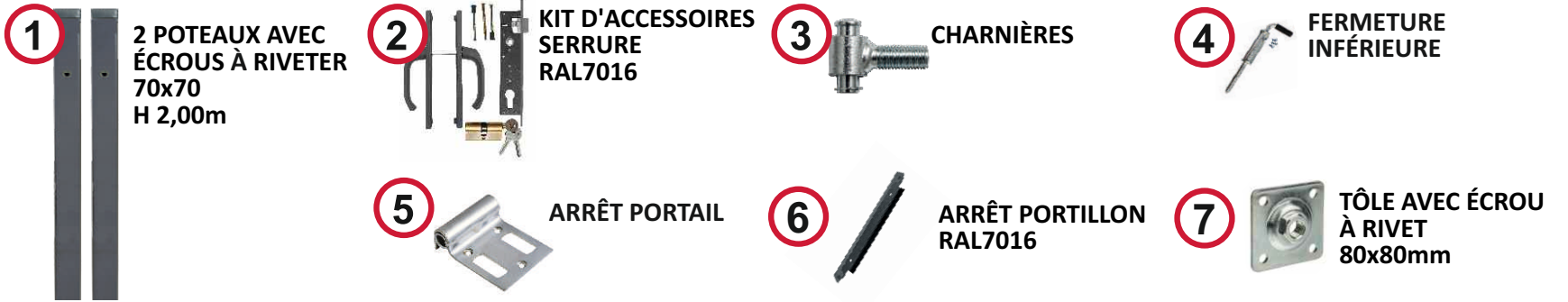

ASSEMBLAGE DE LA TÔLE AVEC SYSTÈME INOX



ASSEMBLAGE DE LA SERRURE ET DES INSERTS

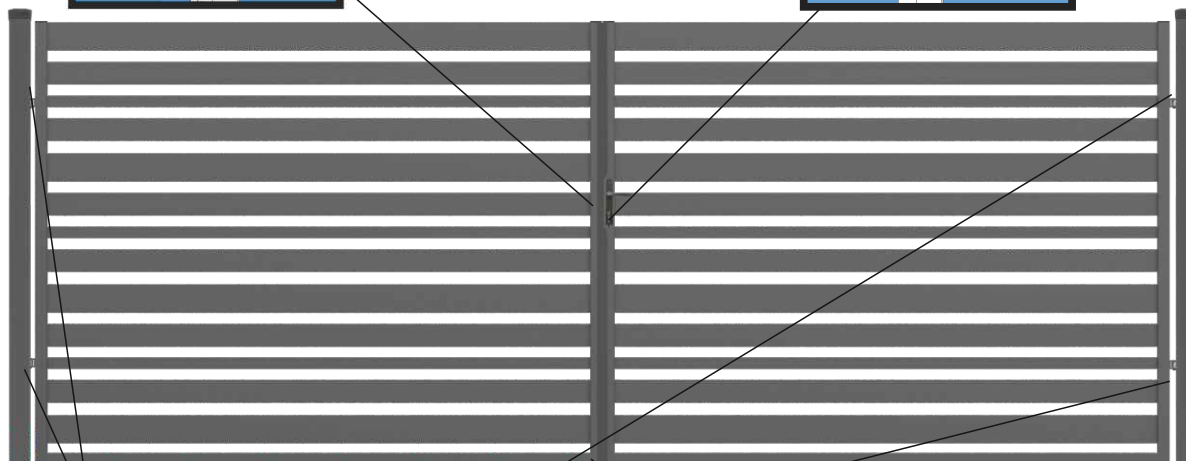
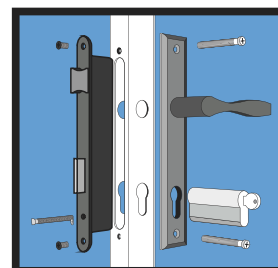

ENSEMBLE DE CHARNIÈRE

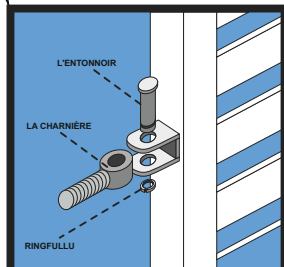

INSTALLATION DE LA SERRURE DU PORTAIL

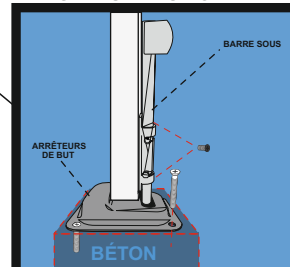

## Systèmes de clôture SASHA



ANTHRACITE (RAL 7016)

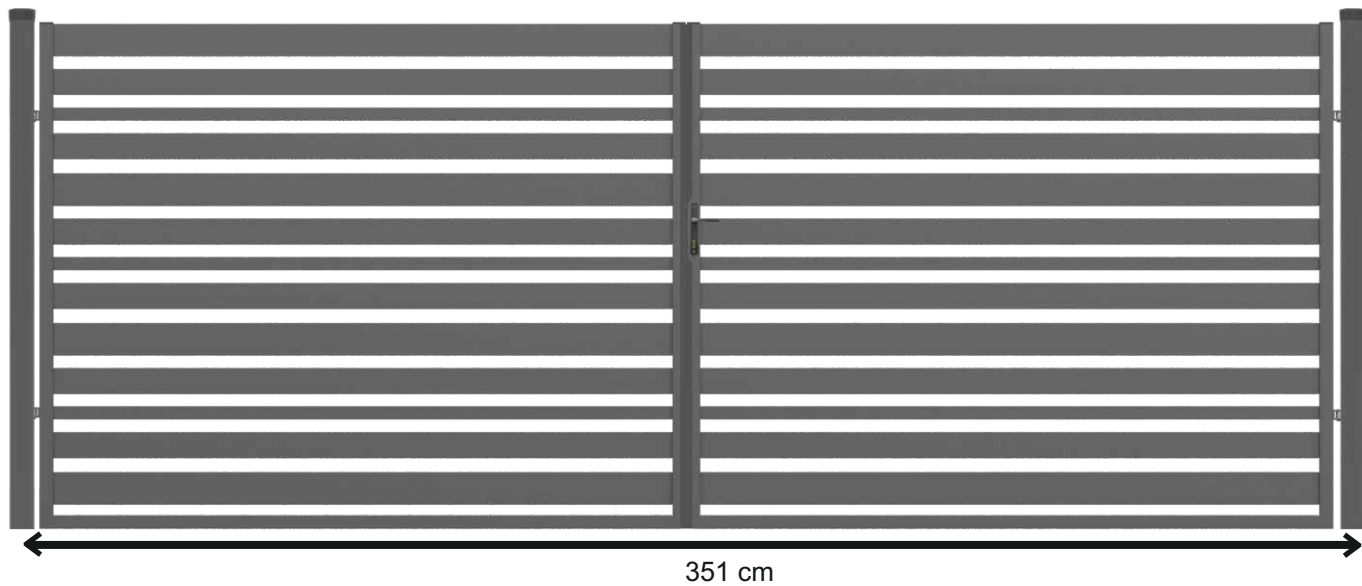

351 cm

### PORTAIL À DOUBLE

- Largeur avec charnières 351 cm

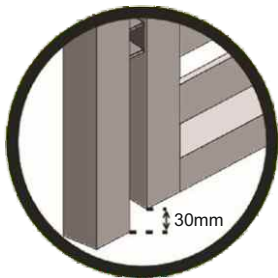

DISTANCE DU BUT  
DEPUIS LE SOL 30 mm





[www.polbram.eu](http://www.polbram.eu)



**POLBRAM** \_\_\_\_\_



**POLBRAM** \_\_\_\_\_

