

## Présentation

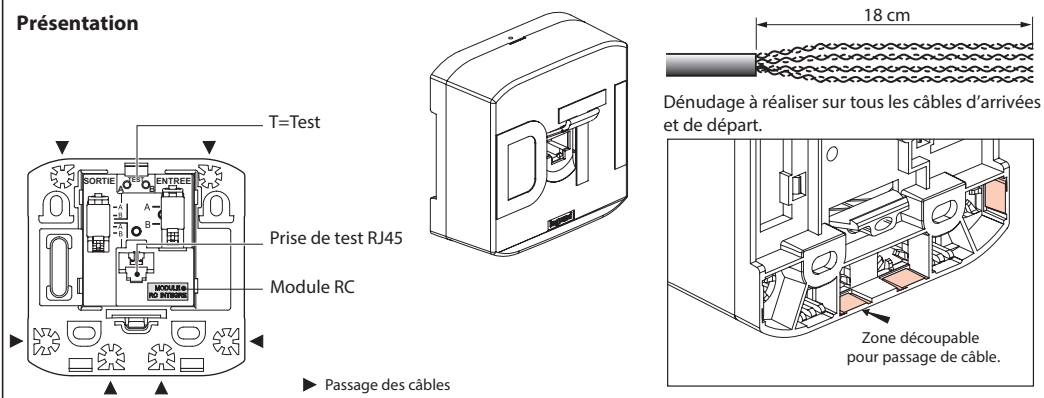

## Implantation

Démontage du couvercle

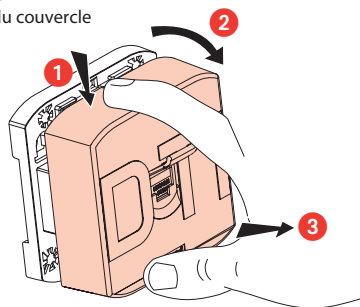

Montage par vis

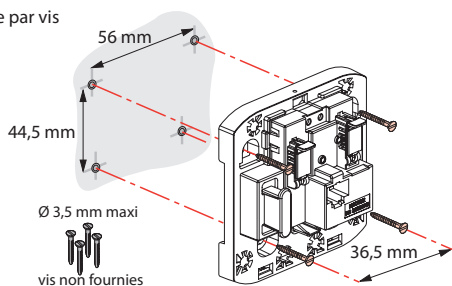

Montage sur rail din

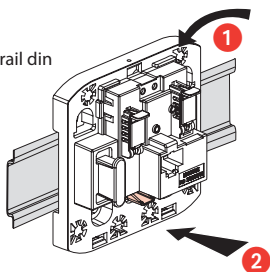

Démontage du rail din

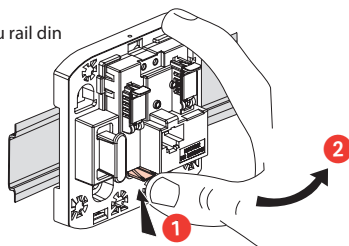

Ø ≤ 7 mm

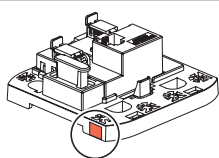

1

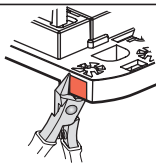

2

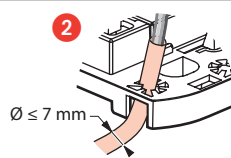

Ø > 7 mm

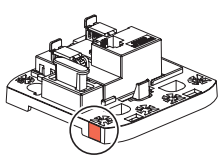

1



2

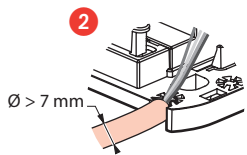

## Schéma d'exploitation

DTI-RJ

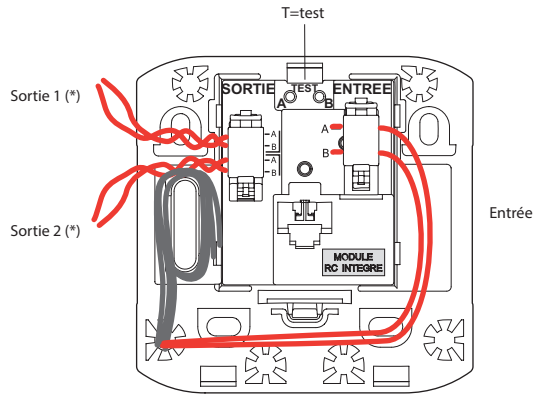
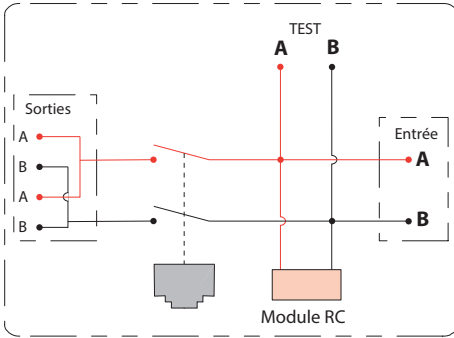

(\*) : Câbles type 4 paires torsadées

## Câblage

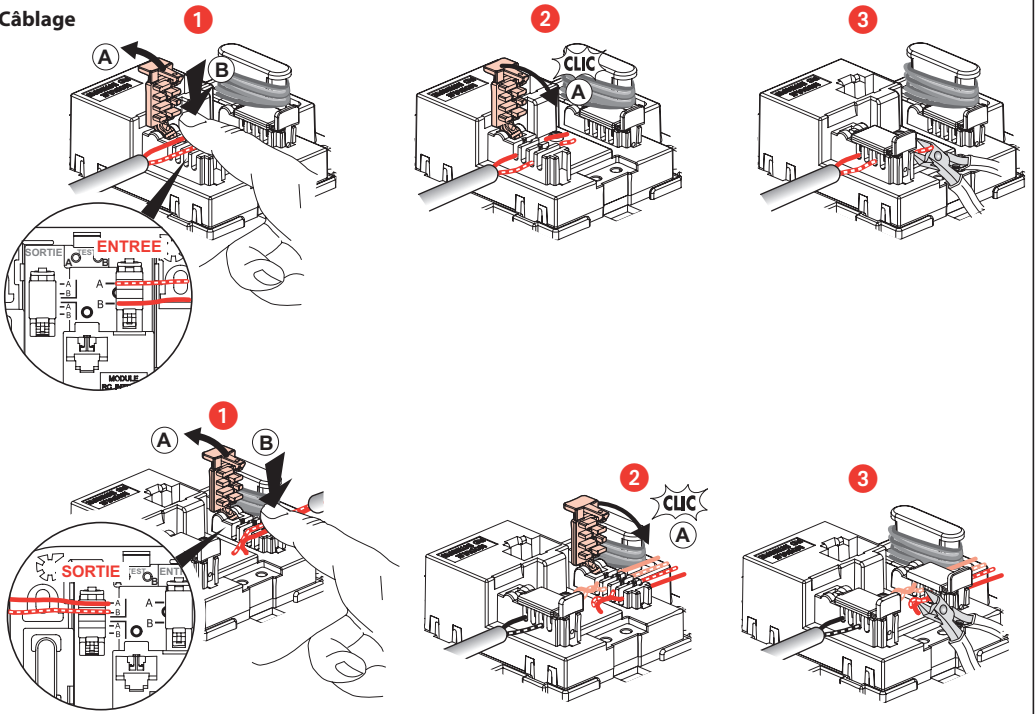

## Test pour vérification du bon fonctionnement de la ligne

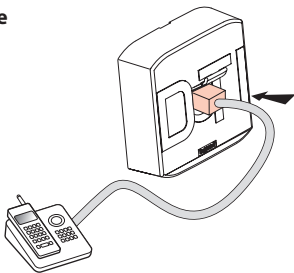

**ATTENTION :** Avant toute intervention, couper le courant.  
Respecter strictement les conditions d'installation et d'utilisation